

New High Feed Insert Size!!

SKG Series - 14mm insert

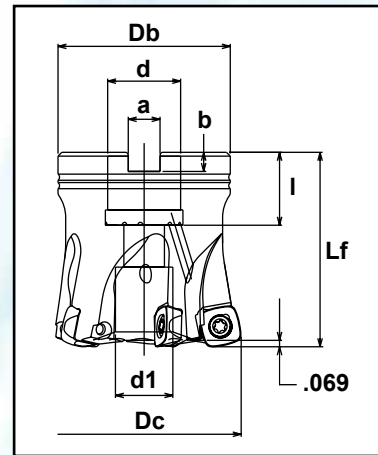

Face Mill

Specifications

CATALOG NUMBER	DIMENSIONS								INSERT	Q	PARTS	
	Dc	Lf	Db	d	d1	a	b	l			Screw	Wrench
SKG-4200R-075-14	2.00	2.00	1.77	.750	.630	.319	.197	.750	SPNW140515ZTR JC8050 or JC8118	4	CSW-513H	A-20
SKG-5250R-100-14	2.50	2.00	1.90	1.00	.787	.374	.236	.945		5		
SKG-6300R-100-14	3.00	2.00	2.21	1.00	.787	.374	.236	.945		6		
SKG-6300R-125-14	3.00	2.50	2.68	1.25	1.02	.500	.315	.866		6		
SKG-6400R-150-14	4.00	2.50	3.00	1.50	1.26	.626	.393	1.02		6		
SKG-7600R-150-14	6.00	2.50	3.93	1.50	1.26	.626	.393	1.02		7		

All cutters supplied without inserts.

New High Feed Insert Size!!

SKG Series - 14mm insert

INSERTS



JC8118



JC8050

Recommended starting speeds & feeds for regular length tools

****NOTE: Corner radius for programming is .137"**

Material	SFM	IPT	DOC	DOC (Max)
Cast Iron	600	.050" / .080"	.080"	.100"
Tool Steel	450	.040" / .060"	.040" / .070"	.080"
Stainless Steel	350	.025" / .050"	.030" / .060"	.080"

NOTE: Call for application support on materials not listed.